

# MAIN LEVEL - STUDENT SERVICES

NOT TO SCALE

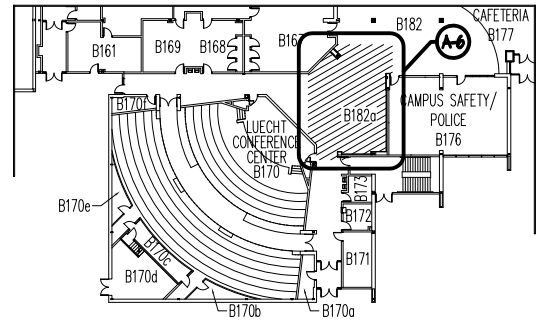



# LOWER LEVEL - BUILDING B

NOT TO SCALE

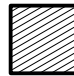

## LEGEND

- |   |              |        |  |
|---|--------------|--------|--|
|  | PAIN WALLS   | FI, F2 | REMOVE EXISTING CARPET AND INSTALL NEW CARPET TILE |
|  | NEW FLOORING | BI     | NEW RUBBER BASE                                    |
|   |              | WI     | NEW PAINT ON EXISTING WALLS                        |

## PAINT SCHEDULE

OFFICES, CLASSROOMS, AND OTHER ROOMS - PROVIDE DEEP TINT ACCENT PAINT ON LARGEST WALL UNLESS NOTED OTHERWISE ON PLANS

## GENERAL NOTES

PAINT AROUND SURFACE RACEWAYS, HM FRAMES, AND COUNTERTOPS  
 DO NOT PAINT EXISTING HOLLOW METAL FRAMES  
 REMOVE FIXED ITEMS FROM THE WALLS SUCH AS MARKER BOARDS, TACK BOARDS, SHELVES AND STANDARDS, ETC.; PAINT WALL; SECURELY REINSTALL ITEMS

**Ruck Pate**

ARCHITECTURE

22102 North Pepper Road, Suite 201  
 Barrington, Illinois 60010

tel 847.381.2946  
 fax 847.304.1218  
 www.ruckpate.com

FALL 2014 CARPET & PAINT  
 McHenry County College  
 8900 US Hwy 14  
 Crystal Lake, Illinois  
 60012

1427.06

**A-1**

31 OCT 2014

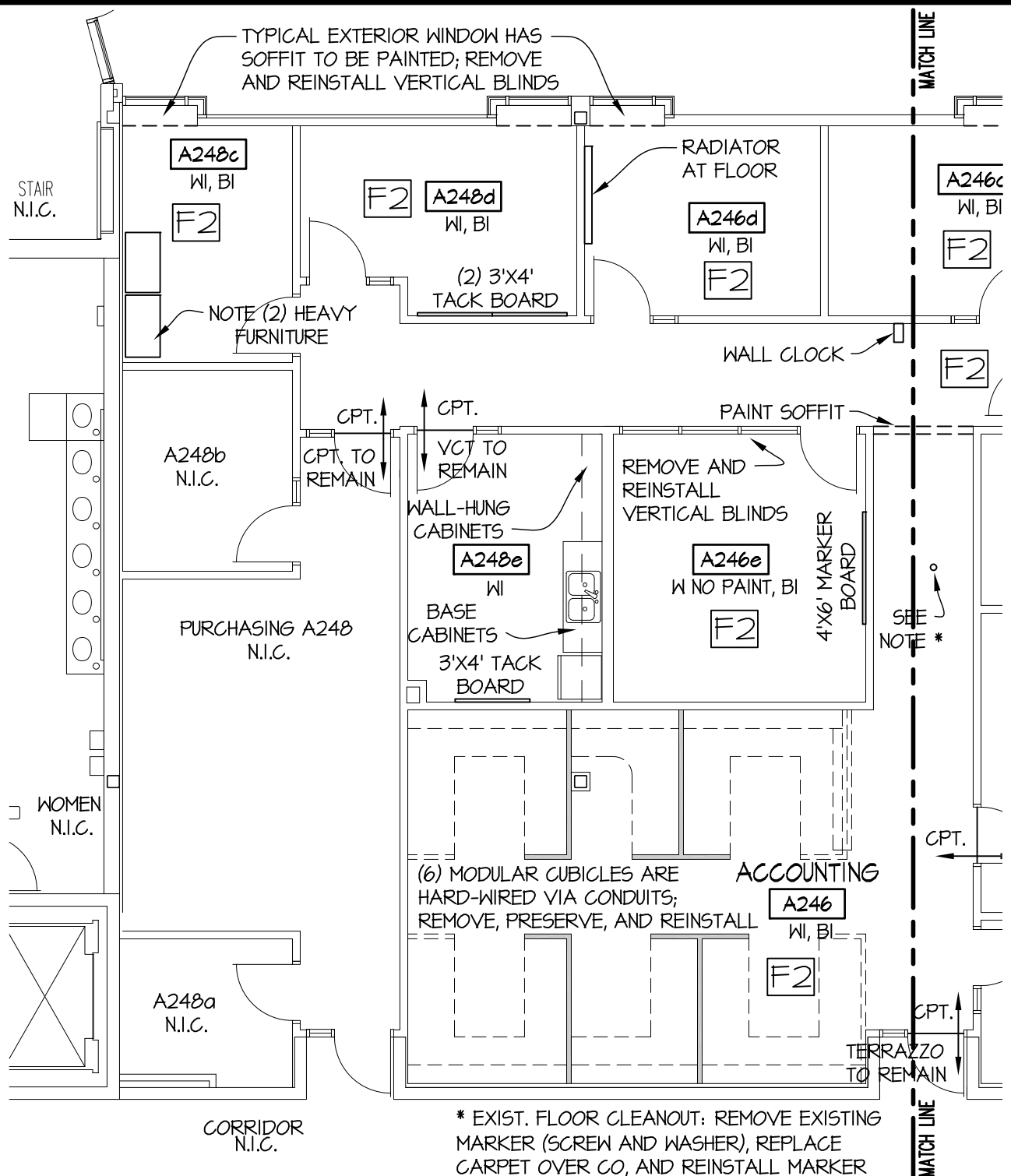

## F1, F2 - CARPET - COLOR PER SPECIFICATIONS

**NOTE: ALL CARPET TILE TO BE INSTALLED IN VERTICAL ASHLAR PATTERN**

# PARTIAL FLOOR PLAN

1/8" = 1'-0"



**Ruck Pate**

ARCHITECTURE

22102 North Pepper Road, Suite 201  
Barrington, Illinois 60010

tel 847.381.2946  
fax 847.304.1218  
www.ruckpate.com

FALL 2014 CARPET & PAINT  
McHenry County College  
8900 US Hwy 14  
Crystal Lake, Illinois  
60012

1427.06

**A-2**

31 OCT 2014

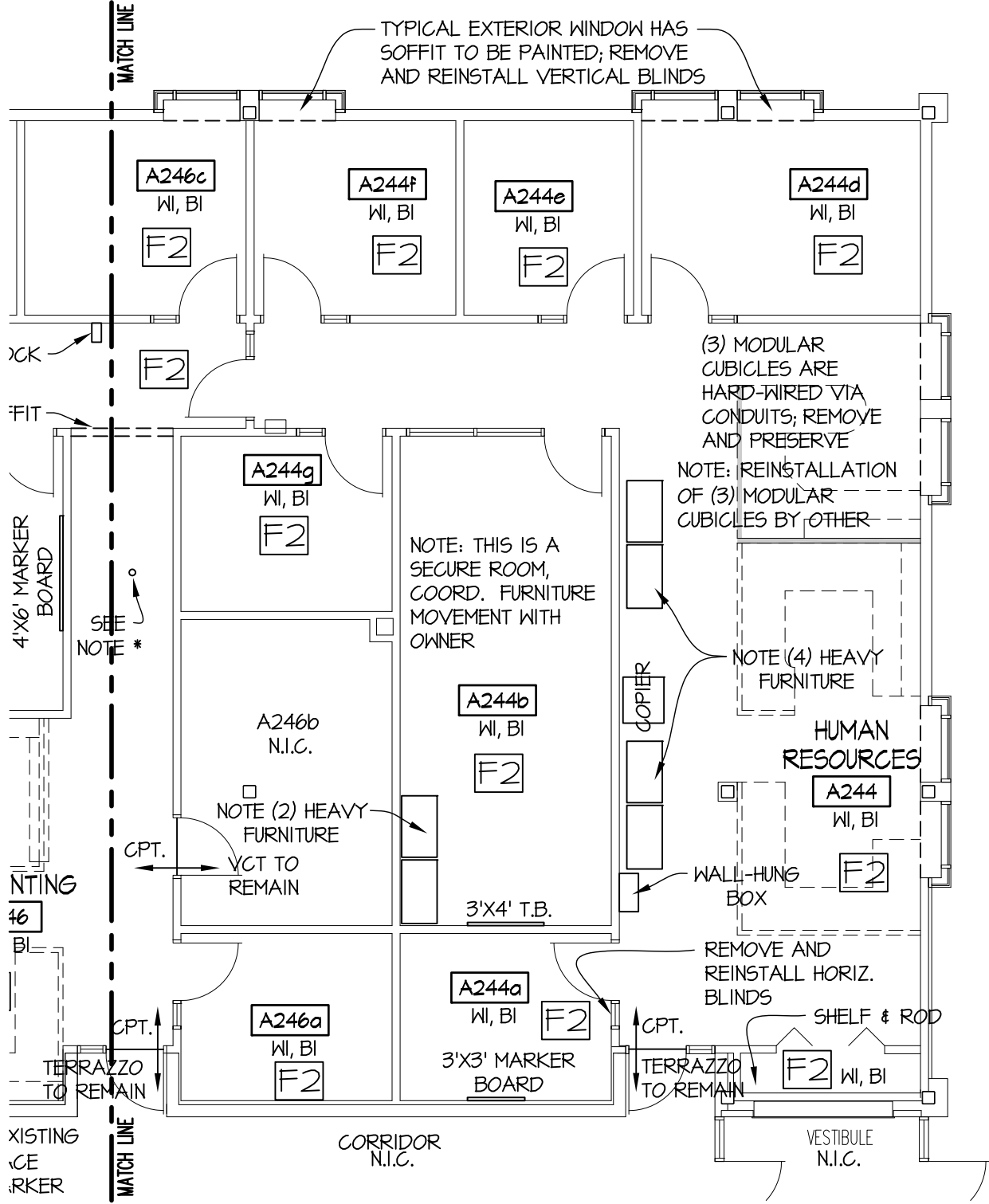

# PARTIAL FLOOR PLAN

1/8" = 1'-0"



<b>Ruck Pate</b> ARCHITECTURE 22102 North Pepper Road, Suite 201 Barrington, Illinois 60010 tel 847.381.2946 fax 847.304.1218 www.ruckpate.com	<b>FALL 2014 CARPET &amp; PAINT</b> McHenry County College 8900 US Hwy 14 Crystal Lake, Illinois 60012	1427.06
		<b>A-3</b>
		31 OCT 2014

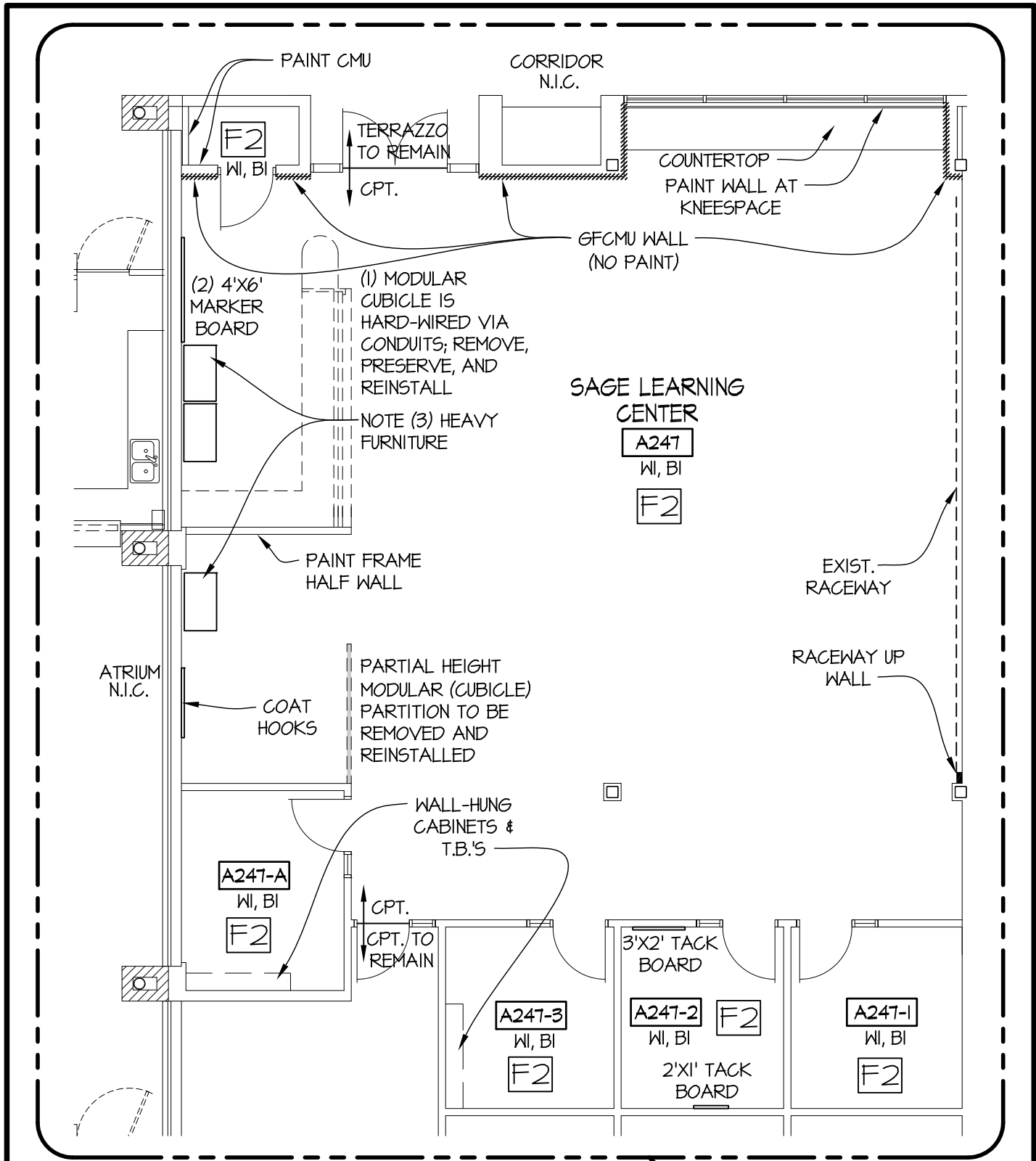

# ALTERNATE #1 PARTIAL FLOOR PLAN

ALTERNATE #1

1/8" = 1'-0"



**Ruck Pate**

ARCHITECTURE

22102 North Pepper Road, Suite 201  
Barrington, Illinois 60010

tel 847.381.2946  
fax 847.304.1218  
www.ruckpate.com

**FALL 2014 CARPET & PAINT**  
**McHenry County College**  
**8900 US Hwy 14**  
**Crystal Lake, Illinois**  
**60012**

1427.06

**A-4**

31 OCT 2014

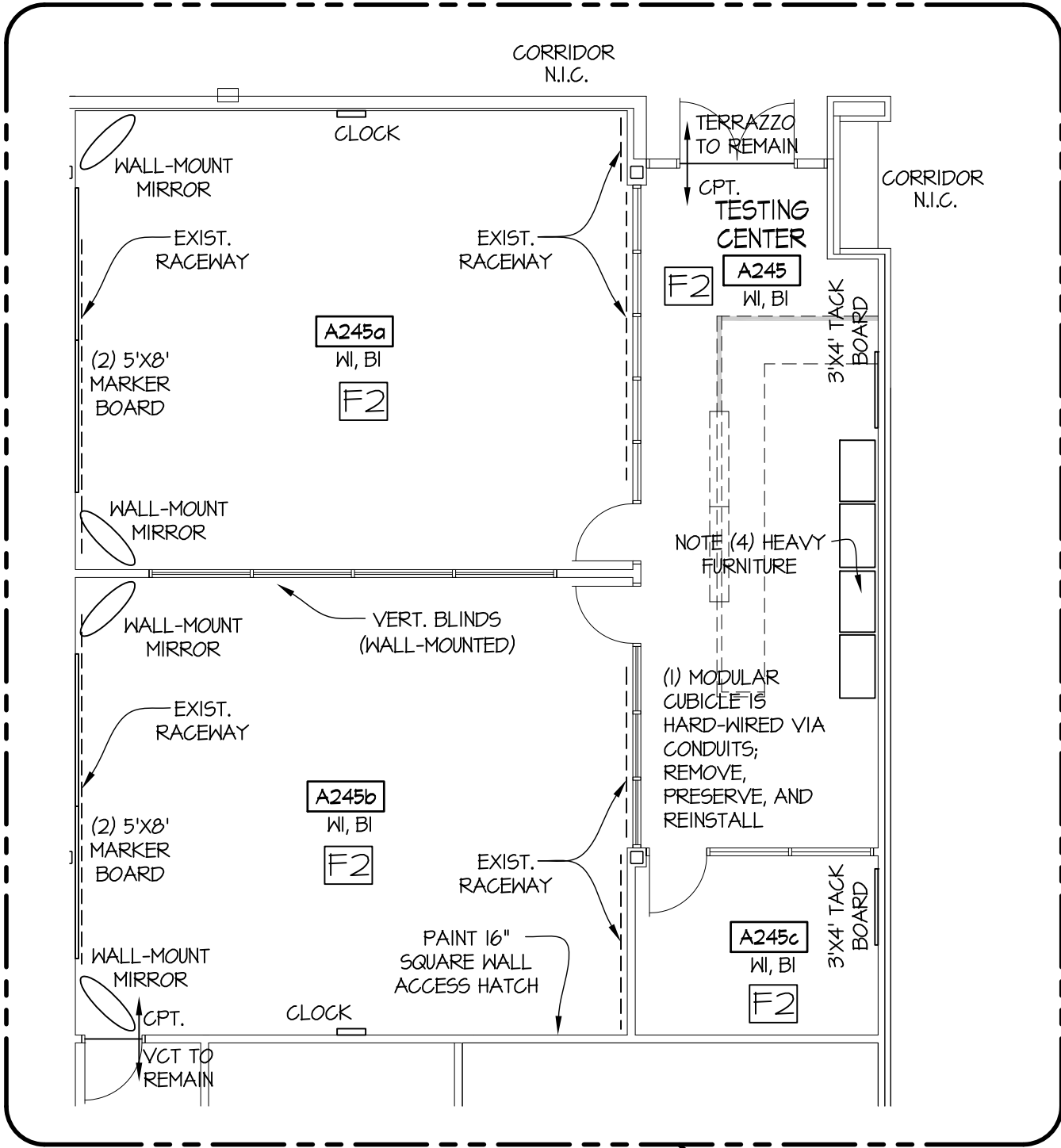

ALTERNATE #2

# ALTERNATE #2 PARTIAL FLOOR PLAN

1/8" = 1'-0"



<b>Ruck Pate</b> ARCHITECTURE 22102 North Pepper Road, Suite 201 Barrington, Illinois 60010 tel 847.381.2946 fax 847.304.1218 www.ruckpate.com	<b>FALL 2014 CARPET &amp; PAINT</b> <b>McHenry County College</b> <b>8900 US Hwy 14</b> <b>Crystal Lake, Illinois</b> <b>60012</b>	1427.06
		<b>A-5</b>
		31 OCT 2014

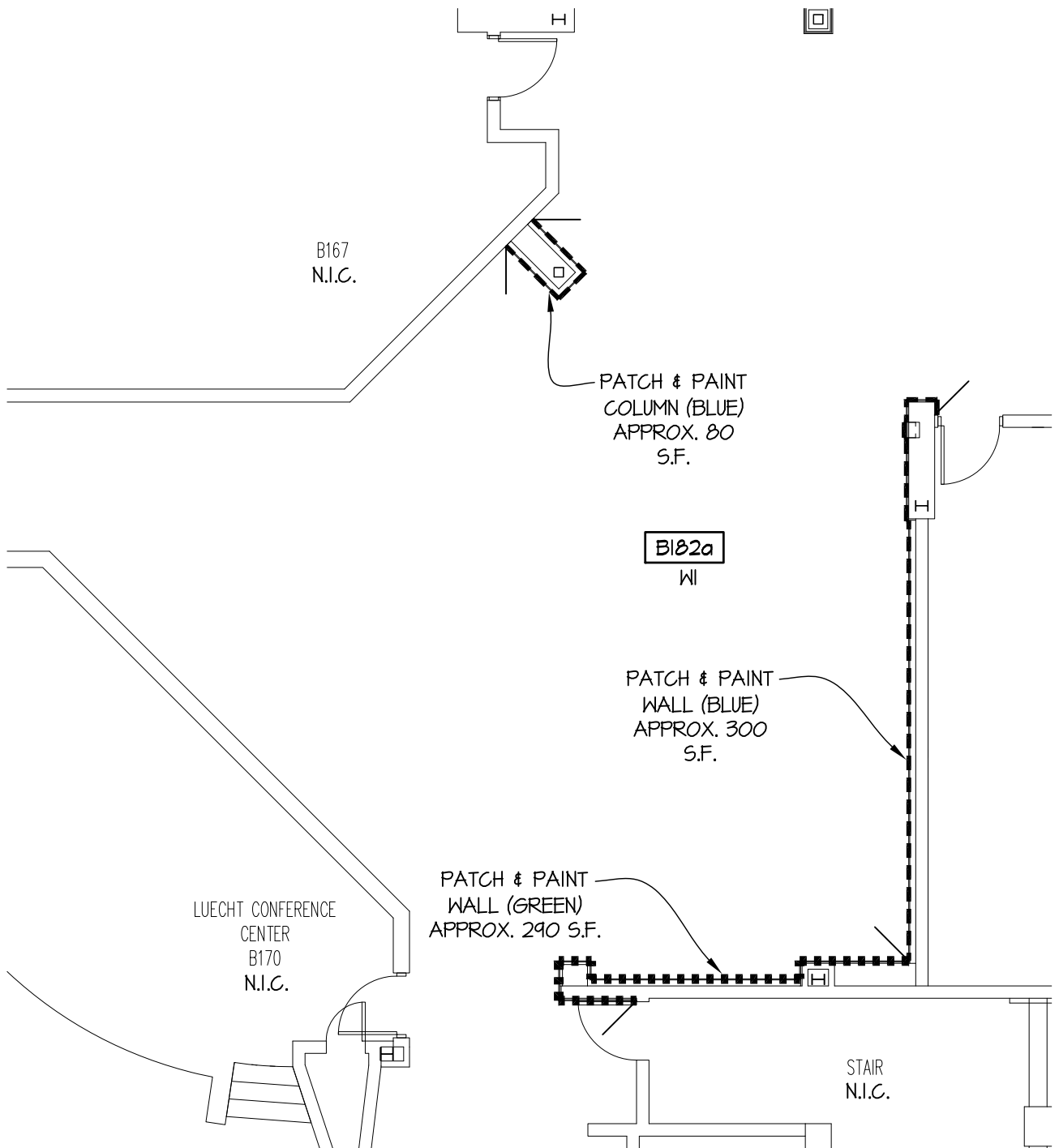

**(GREEN) - MATCH "TERRAPIN GREEN" BM #2145-20**  
**(BLUE) - MATCH "COOL BLUE" BM #2058-40**

## PARTIAL FLOOR PLAN

1/8" = 1'-0"



**Ruck Pate**

ARCHITECTURE

22102 North Pepper Road, Suite 201  
Barrington, Illinois 60010

tel 847.381.2946  
fax 847.304.1218  
www.ruckpate.com

FALL 2014 CARPET & PAINT  
McHenry County College  
8900 US Hwy 14  
Crystal Lake, Illinois  
60012

1427.06

**A-6**

31 OCT 2014

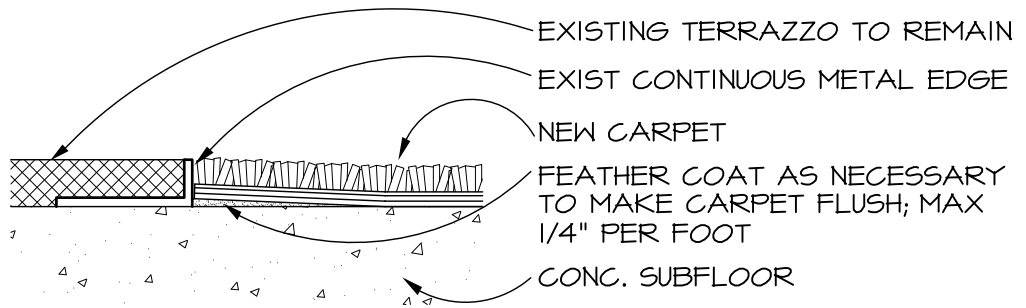

**1**

## TERRAZZO TO CARPET TRANSITION

N.T.S.

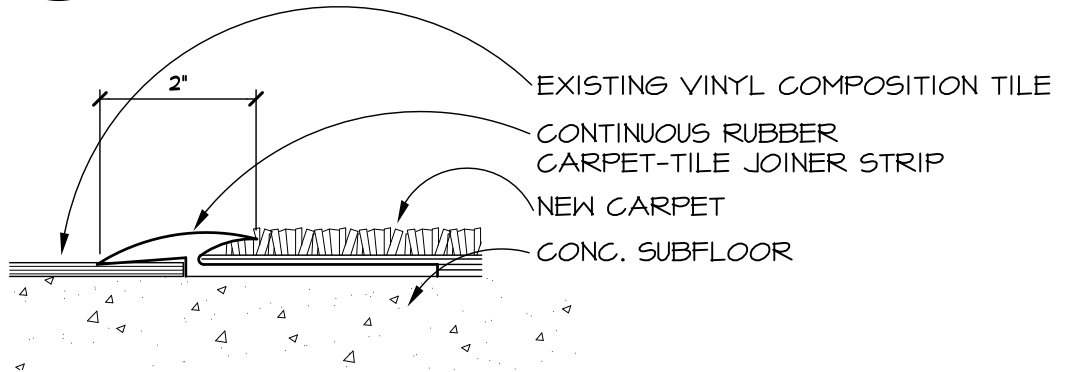

**2**

## VCT TO CARPET TRANSITION

N.T.S.

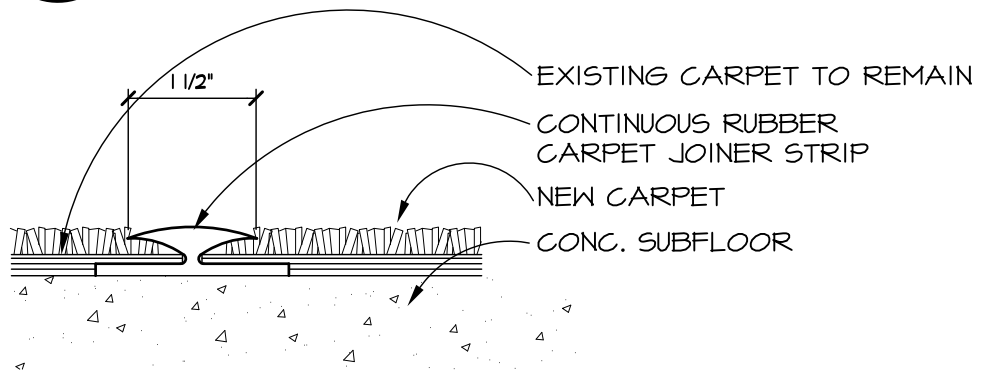

**3**

## CARPET TO CARPET TRANSITION

N.T.S.

**Ruck Pate**  
ARCHITECTURE

22102 North Pepper Road, Suite 201  
Barrington, Illinois 60010

tel 847.381.2946  
fax 847.304.1218  
www.ruckpate.com

FALL 2014 CARPET & PAINT  
McHenry County College  
8900 US Hwy 14  
Crystal Lake, Illinois  
60012

1427.06

**A-7**

31 OCT 2014